

Lalina wall wash



Our Lalina luminaire is field curvable to conform to rounded architectural coves. A wall-facing precision engineered asymmetric optic provides even, and effective wall washing. Nominal lengths are field cuttable.

Features

- Patent pending
- Field curvable and cuttable flexible housing and lens
- Specifiable outputs available
- Specifiable color temperature. CRI > 90, R9 >50
- Remote, specifiable dimmable drivers or PoE
- 5 Year, 50,000 hour warranty, damp location rated
- WELL Building Standard compatible [learn more](#)

Dimensions

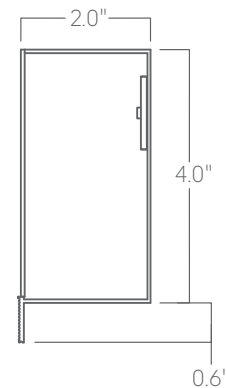

Optics

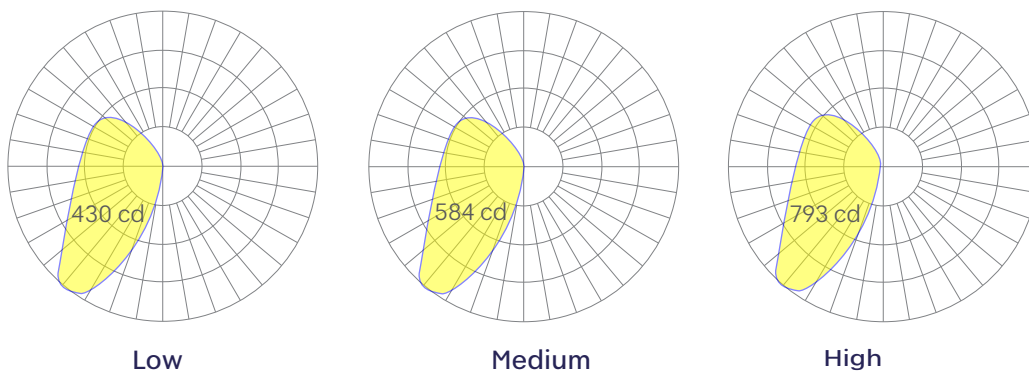

Representative distribution and peak candela. For other options see order information or IES files [here](#).

Lalina wall wash

Ordering Information

For each option group below specify one option. If you don't see your preferred option listed, contact us for [help](#).

1	Fixture ID	2	Length	3	Color Temperature	4	Output
	LALINA-WW-STR (Straight) LALINA-WW-CRV (Curved)	2	2 ft	27	2700K/90 CRI	LOW	Low output
		4	4 ft	30	3000K/90 CRI	MED	Medium output
		8	8 ft	35	3500K/90 CRI	HIGH	High output
		X'-X"	Specify Length	40	4000K/90 CRI	CUST	Custom output Specify Watts or lumens
		PAT	Pattern (Consult Factory)	50	5000K/90 CRI		
5	Voltage	6	Driver	7	Finish	8	Mounting
	UNV Universal (120/277V) 347V 347V Available for DB Driver only	DB Standard 0-10V 1%		W	White	NT	Mud-In Flange
		DB.1% 0-10V 0.1%					
		ELV Reverse Phase 1% (120V only) For compatible dimmers see here .					
		TRI Forward phase (120V only) For compatible dimmers see here .					
		LDE Lutron Digital EcoSystem					
		DALI DALI-2 Driver					
		PoE Power over Ethernet					
9	Optics	10	Sensors/Controls	11	Circuit	12	Options
	SD Standard Diffuser	NA None		NA None		NA None	
		ACM Acuity nLight Module Only		EMPCK Emergency battery pack Supplied in remote enclosure			
		CCS Casambi Module		EMCKT Emergency circuit May require additional power feeds			
		AWNR Lutron Athena Wireless Node Module					
		OTHER Consult Factory					
		All controls remote.					

Performance

Output ¹	Watts/ft	Lumens/ft
Low	5	494
Medium	7	672
High	10	912

¹Based on a typically configured 90 CRI and 3500K luminaire using one driver.
Note: Output values were calculated in Photopia and Coronet is not responsible for real output disparities.
Custom outputs available. Please consult factory.
For 4000K multiply by 105; for 3000K, 0.9%; for 2700K, 0.92.

Technical Information



click [here](#) or scan QR code

Wiring diagrams, PoE and sensor details

Lalina wall wash

Drivers & Electrical

Remote drivers with 0-10V Dimming standard. Several other driver options available; see ordering information. For remote driver box sizes, click [here](#).

Emergency Back-Up

For fixtures three-feet or longer, a 4W remote emergency driver may be wired to 4ft sections. 7W, 10W, and 12W drivers are also available. Emergency circuits for use with building generators are also available.

Weight

5 lbs per foot

Optics

Extruded satin acrylic lenses provide excellent diffusion and high transmission.

PoE (Power over Ethernet)

Compatible with virtually all PoE systems including Molex Coresync, Igor, Smartengine, Platformatics, and NuLED SPICEbox. Consult Factory for systems not listed, See [here](#) for more info.

Finishes

All luminaires are finished in high quality polyester powder coating. Our standard color is white.

Mounting

