

LSR1 Low Profile recessed

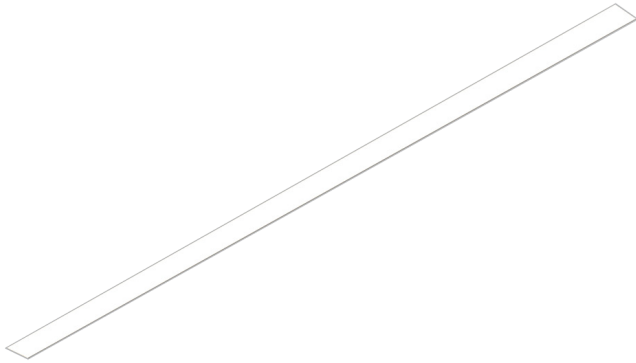

The LS Series of architectural luminaires offers a wide range of profiles and mounting options. Custom lengths and patterns are tailored to suit any modern space.

Features

- Extruded recycled aluminum housing
- Aluminum core LED boards, specifiable optics
- Specifiable color temperature. CRI > 90, R9 > 50
- Custom lengths, welded patterns, and finishes available
- Integral specifiable dimmable drivers or PoE
- 5 Year, 50,000 hour warranty, damp location rated
- Compatible with all wood ceilings
- WELL Building Standard compatible [learn more](#)

Dimensions

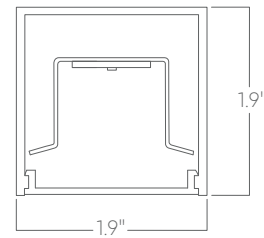

Optics

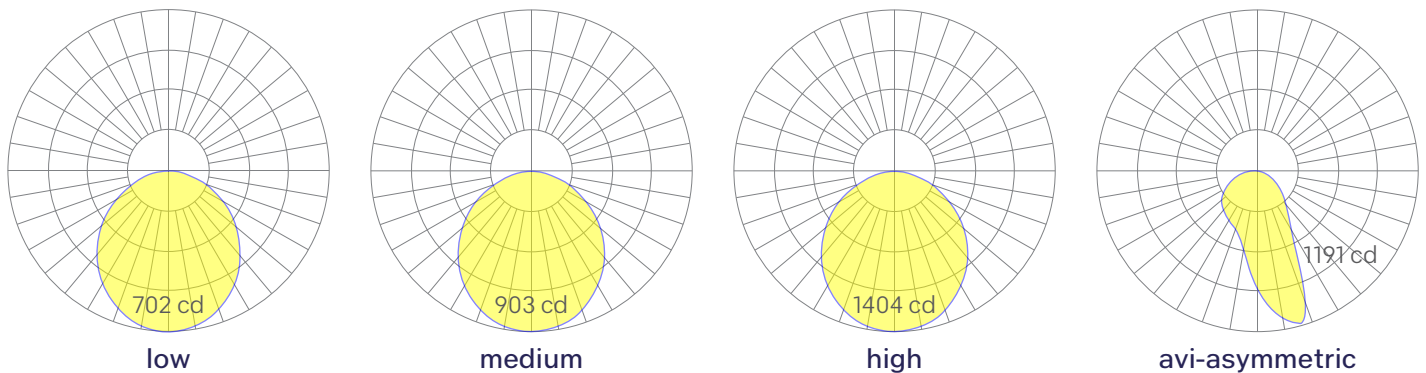

Representative distribution and peak candela. For other options see order information or IES files [here](#).

LSR1 Low Profile recessed

Ordering Information

For each option group below specify one option. If you don't see your preferred option listed, contact us for [help](#).

1	Fixture ID	2	Length	3	Color Temperature	4	Output
	LSR1 LP	2	2 ft	27	2700K/90 CRI	LOW	Low output
		4	4 ft	30	3000K/90 CRI	MED	Medium output
		8	8 ft	35	3500K/90 CRI	HIGH	High output
		X'-X"	Specify Length	40	4000K/90 CRI	CUST	Custom output Specify Watts or lumens
		PAT	Pattern (Consult Factory)	50	5000K/90 CRI		
				WD	Warm Dim 2200K-3000K Must use WD10 driver		
				TW	Tunable White 2700K-6500K Must use WD10 or PSQ driver		
				RGBW30	RGB +white, 3000k Remote DMX. High output unavailable.		
				RGBW35	RGB +white, 3500k Remote DMX. High output unavailable.		
				RGBW40	RGB +white, 4000k Remote DMX. High output unavailable.		
5	Voltage	6	Driver	7	Finish	8	Mounting
UNV	Universal (120/277V)	DB	Standard 0-10V 1%	W	White	T	9/16" Tee Grid
347V	347V Available for DB Driver only	DB.1%	0-10V 0.1%	BLK	Black	T15	15/16" Tee Grid
		ELV	Reverse Phase 1% (120V only) For compatible dimmers see here .	SLV	Silver	SG	Slot Grid/Interlude
		TRI	Forward phase (120V only) For compatible dimmers see here .	CC	Custom Color See finish options here .	F	Flange
		LDE	Lutron Digital EcoSystem	CWF	Custom Wood Finish See finish options here .	NT	Mud-in Flange
		DALI	DALI-2 Driver			PM-X	Perimeter Mount 'X' denotes mounting type on opposite side of wall (eg PM-NT).
		PoE	Power over ethernet.			WOOD	Wood ceiling Provide specifications.
		TW10	Dual channel, 0-10V for tunable white.				
		WD10	0-10V Warm Dim				
		PSQ	Lutron T-Series 2-channel 1% for tunable white				
		DMX	DMX512 All DMX drivers set to default address 001 and provided in remote enclosers. Contact us for other addressing needs				
9	Optics	10	Sensors/Controls	11	Circuit	12	Options
FL	Flat diffuser	NA	None	NA	None	NA	None
AVI ASY	Asymmetric optic	ACM	Acuity nLight Module Only	EMPCK	Emergency battery pack May require additional power feeds.	WH	6ft whips
		CCS	Casambi Module	EMCKT	Emergency circuit May require additional power feeds.	CP	Chicago Plenum
		AWNR	Lutron Athena Wireless Node Module	DAYCKT	Daylight circuit May require additional power feeds.		
		OTHER	Consult Factory				

Performance

Output ¹	Watts/ft	Lumens/ft	LPW
Low	5	474	95
Medium	7	677	97*
High	10	948	95

¹Based on a typically configured 90 CRI, 3500K luminaire using one driver.
Custom outputs available. Please consult factory.

For 4000K multiply by 1.05; for 3000K, 0.9%; for 2700K, 0.92.

*80 CRI equivalent 115 LPW

Technical Information



click [here](#) or scan QR code

Wiring diagrams, PoE and sensor details

LSR1 Low Profile recessed

Drivers & Electrical

Remote, dimmable drivers are supplied in enclosures.
For remote driver box sizes, click [here](#).

Emergency Back-Up

For fixtures three-feet or longer, a 4W integral emergency driver may be wired to 4ft sections. 7W, 10W, and 12W drivers are also available (not all integral; consult factory). Emergency circuits for use with building generators are also available.

PoE (Power over Ethernet)

Compatible with virtually all PoE systems including Moxel Coresync, Igor, Smartengine, Platformatics, and NuLED SPICEbox.
Consult factory for systems not listed. See [here](#) for more info.

Finishes

All luminaires are finished in high quality polyester powder coating. Our standard color is white. Any RAL color may be specified.

Weight

3 lbs per foot

Optics

Extruded satin acrylic lenses provide excellent diffusion, high transmission, and no LED imaging. Black Optic and glare-free, beam-controlling TIR optics are available for some models.

Construction

Extruded, recycled aluminum housing.

Joined Runs

Runs of any length may be specified and are comprised of multiple, factory-engineered, joined sections. Individually specified luminaires are not field joinable.

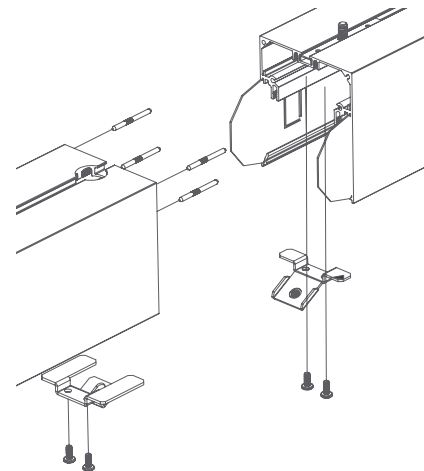

Representative joinery. For product specific details see installation guides or submittal drawings.

Patterns

Featuring illuminated welded corners and angles. Consult factory for custom designs and elevations.

Square



X

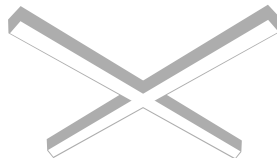

T

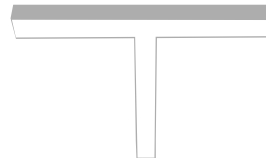

V



Custom

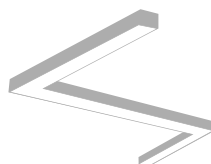

Wall/Ceiling



LSR1 Low Profile recessed

Mounting Options

Custom mounting types and ceiling transitions available; consult factory.

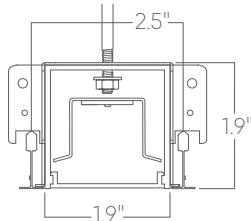

T
9/16" tee grid

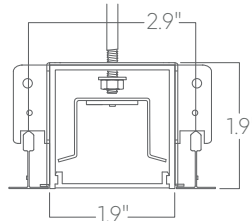

T15
15/16" tee grid

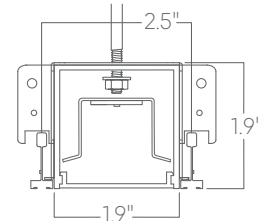

SG
slot grid

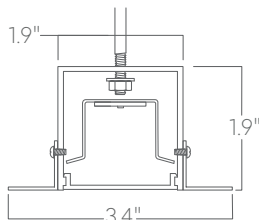

F
flange

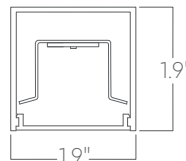

WOOD
provide specifications

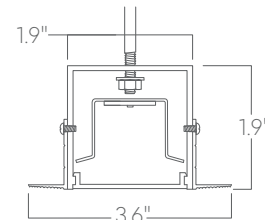

NT
mud-in¹

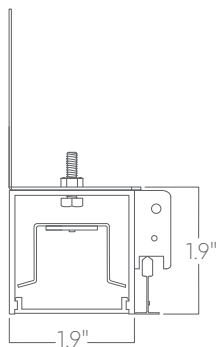

PM-T
perimeter to 9/16" tee grid

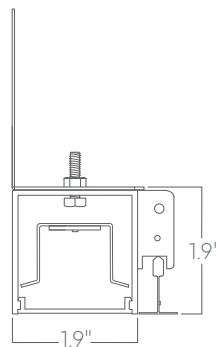

PM-T15
perimeter to 15/16" tee grid

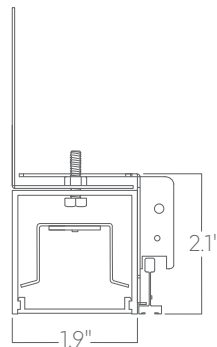

PM-SG
perimeter to slot grid

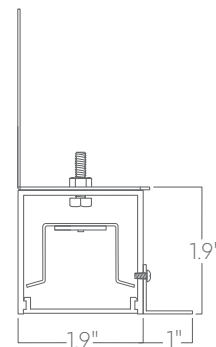

PM-F
perimeter to flange

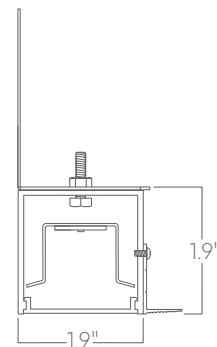

PM-NT
perimeter to mud-in

¹Installation that alters aperture width compromises lens security. Installer must ensure aperture width is maintained.

Please consult factory shop drawings for suspension points.

To prevent damage to fixtures, factory designated suspension points must not be field altered.

Do not attempt installation if you do not understand the installation instructions.