

LSR1 Sharp recessed

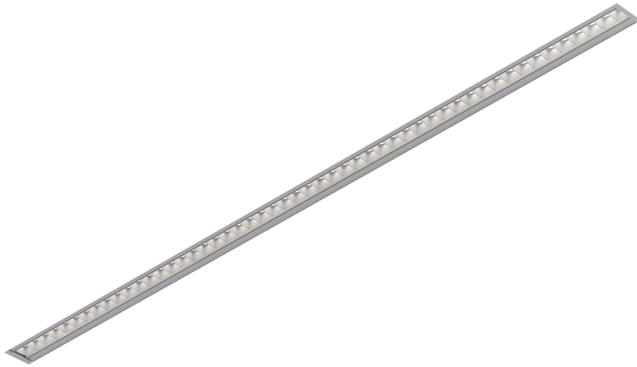

The Sharp Series of architectural luminaires features slim profiles, glare-free, beam shaping optical cells and several mounting options. Custom lengths are tailored to suit any modern space.

Features

- Extruded recycled aluminum housing
- Glare-free, beam shaping optical cells
- Aluminum core LED boards, specifiable optics
- Specifiable color temperature. CRI > 90, R9 > 50
- Custom finishes available
- Specifiable dimmable drivers or PoE
- 5 Year, 50,000 hour warranty, damp location rated
- Compatible with all wood ceilings
- WELL Building Standard compatible [learn more](#)

Dimensions

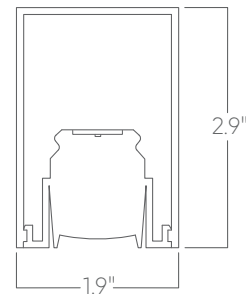

Optics

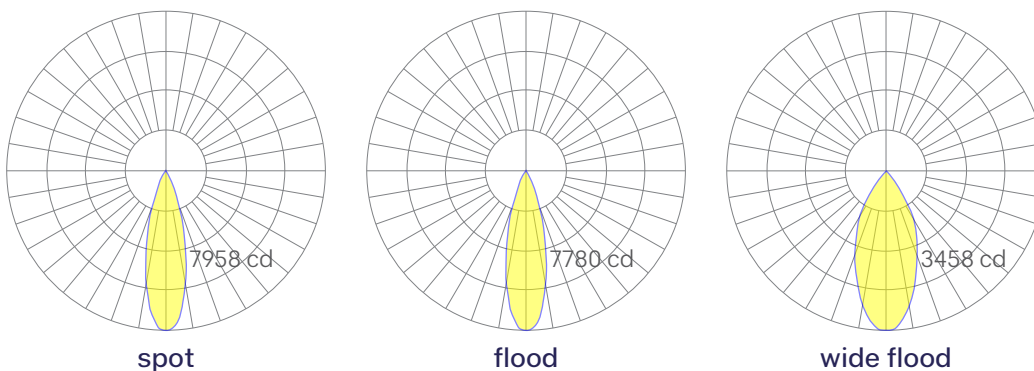

Representative distribution and peak candela. For other options see order information or IES files [here](#).

LSR1 Sharp recessed

Ordering Information

For each option group below specify one option. If you don't see your preferred option listed, contact us for [help](#).

1 Fixture ID	2 Length	3 Color Temperature	4 Output
LSR1 SHARP	2 2 ft nominal 4 4 ft nominal 8 8 ft nominal X'X" Specify Length <small>Custom lengths available in 12" nominal increments</small>	27 2700K/90 CRI 30 3000K/90 CRI 35 3500K/90 CRI 40 4000K/90 CRI	LOW Low output MED Medium output HIGH High output CUST Custom output <small>Specify Watts or lumens</small>
5 Voltage	6 Driver	7 Finish	8 Mounting
UNV Universal (120/277V) 347V 347V <small>Available for DB Driver only</small>	DB Standard 0-10V 1% DB.1% 0-10V 0.1% ELV Reverse Phase 1% (120V only) <small>For compatible dimmers see here.</small> TRI Forward phase (120V only) <small>For compatible dimmers see here.</small> LDE1 Lutron Digital EcoSystem DALI DALI-2 Driver PoE Power over Ethernet. DMX DMX512 <small>All DMX drivers set to default address 001 and provided in remote enclosures. Contact us for other addressing needs.</small>	Housing W White BLK Black CC Custom Color <small>See finish options here.</small> Louver W White BLK Black	T 9/16" Tee Grid T15 15/16" Tee Grid SG Slot Grid/Interlude F Flange <small>Remote drivers required.</small> NT Mud-in Flange <small>Remote drivers required.</small> PM-X Perimeter Mount <small>'X' denotes mounting type on opposite side of wall (eg PM-NT).</small> WOOD Wood ceiling <small>Provide specifications.</small>
9 Optics	10 Sensors/Controls	11 Circuit	12 Options
SP 24° beam FL 30° beam WFL 44° beam	NA None ACM Acuity nLight Module Only CCS Casambi Module AWNDR Lutron Athena Wireless Node Module OTHER Consult Factory <small>All controls remote.</small>	NA None EMPKK Emergency battery pack <small>May require additional power feeds.</small> EMCKT Emergency circuit <small>May require additional power feeds.</small> DAYCKT Daylight circuit <small>May require additional power feeds.</small>	NA None WH 6ft whips CP Chicago Plenum

Performance

Output ¹	Watts/ft	Lumens/ft
Low	5	419
Medium	7	609
High	10	910

¹Based on a typically configured 90 CRI, 3500K luminaire using one driver. Custom outputs available. Please consult factory. For 4000K multiply by 1.05, for 3000K, 0.9%, for 2700K, 0.92.

Technical Information



click [here](#) or scan QR code

Wiring diagrams, PoE and sensor details

LSR1 Sharp recessed

Drivers & Electrical

Remote, dimmable drivers are supplied in enclosures.

For remote driver box sizes, click [here](#).

Emergency Back-Up

For fixtures three-feet or longer, a 4W remote emergency driver may be wired to 4ft sections. 7W, 10W, and 12W drivers are also available. Emergency circuits for use with building generators are also available.

PoE (Power over Ethernet)

Compatible with virtually all PoE systems including Moxel Coresync, Igor, Smartengine, Platformatics, and NuLED SPICEbox.

Consult factory for systems not listed. See [here](#) for more info.

Finishes

All luminaires are finished in high quality polyester powder coating. Our standard color is white. Any RAL color may be specified.

Weight

6 lbs per foot

Optics

Glare-free, beam shaping optical cells. Access inside the fixture is not available after baffles are installed. For no trim or flanged fixtures, the baffle is shipped separately from the main fixture and is installed after the main one.

Construction

Extruded, recycled aluminum housing with formed steel ends.

Joined Runs

Runs of any length¹ may be specified and are comprised of multiple, factory-engineered, joined sections. Individually specified luminaires are not field joinable.

¹Custom lengths available in 12" nominal increments.

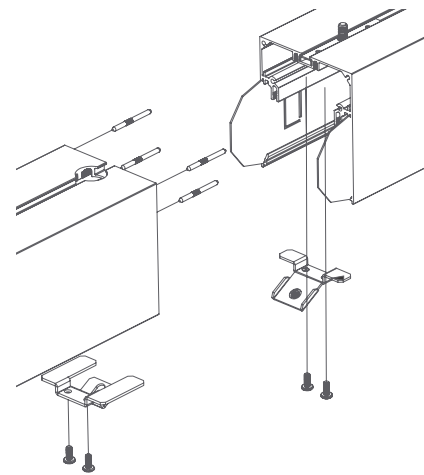

Representative joinery. For product specific details see installation guides or submittal drawings.

LSR1 Sharp recessed

Mounting Options

Custom mounting types and ceiling transitions available; consult factory.

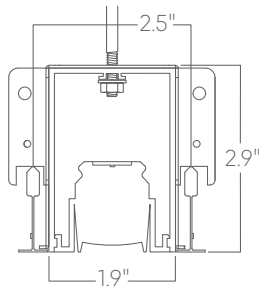

T
9/16" tee grid

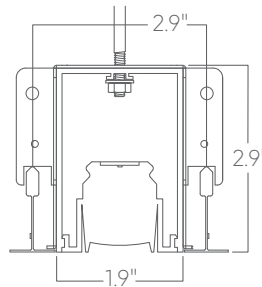

T15
15/16" tee grid

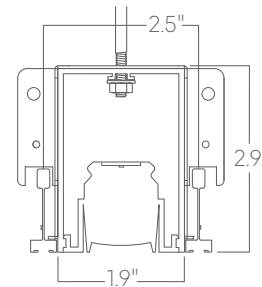

SG
slot grid

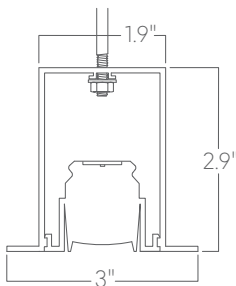

F
flange

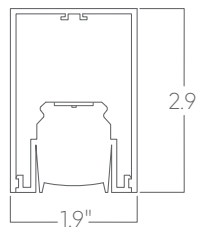

WOOD
provide specifications

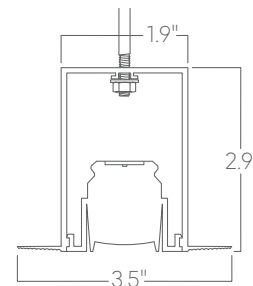

NT
mud-in

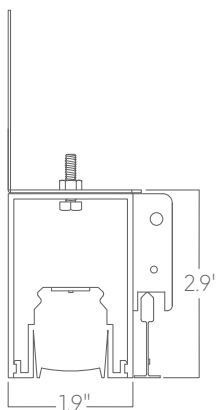

PM-T
perimeter to 9/16" tee grid

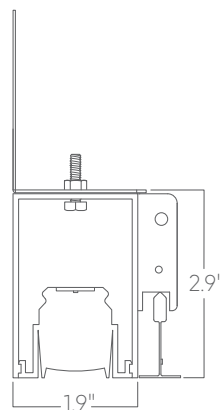

PM-T15
perimeter to 15/16" tee grid

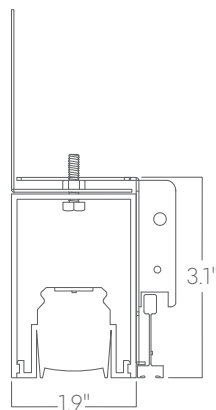

PM-SG
perimeter to slot grid

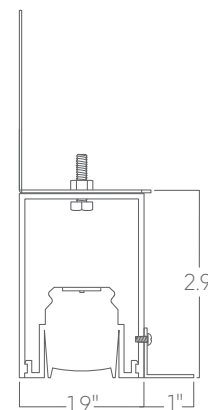

PM-F
perimeter to flange

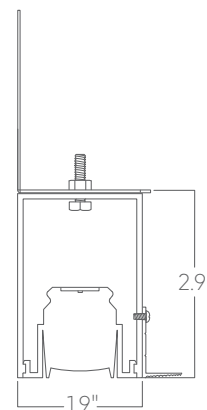

PM-NT
perimeter to mud-in

Please consult factory shop drawings for suspension points.

To prevent damage to fixtures, factory designated suspension points must not be field altered.

Do not attempt installation if you do not understand the installation instructions.